

Isotop SE light

Sandwich element for universal use

- Natural frequency from 10.8 Hz
- 5 mm hot dip galvanised steel plate for pressure distribution with 3 mm anti-slip plate
- Insulating layer made from 25 mm Sylomer®
- Connection to the device by means of friction (without screw-fixing)
- Suitable for different frame widths
- Quick and easy to install

			Maximum load		Natural frequency at maximum load	Packaging unit	Order number
			in kg	in N			
 SE light	Isotop SE light 6-1	Single layer	63	618	12.7 Hz	4 pcs.	45949
	Isotop SE light 12-1	Single layer	123	1,206	11.7 Hz	4 pcs.	45950
	Isotop SE light 24-1	Single layer	240	2,354	11.8 Hz	4 pcs.	45951
	Isotop SE light 47-1	Single layer	470	4,610	10.8 Hz	4 pcs.	45952
	Isotop SE light 93-1	Single layer	930	9,123	11.0 Hz	4 pcs.	45953

Isotop SE light (unloaded)

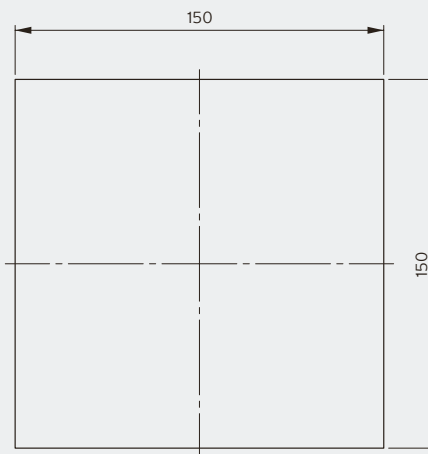
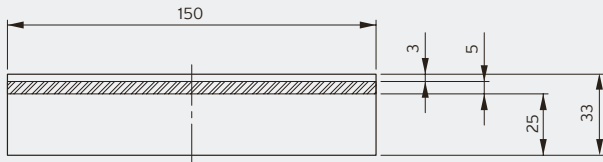

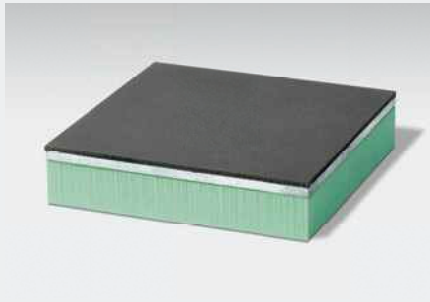

Isotop SE light



Air conditioning unit on Isotop SE light

Isotop SE light 6-1

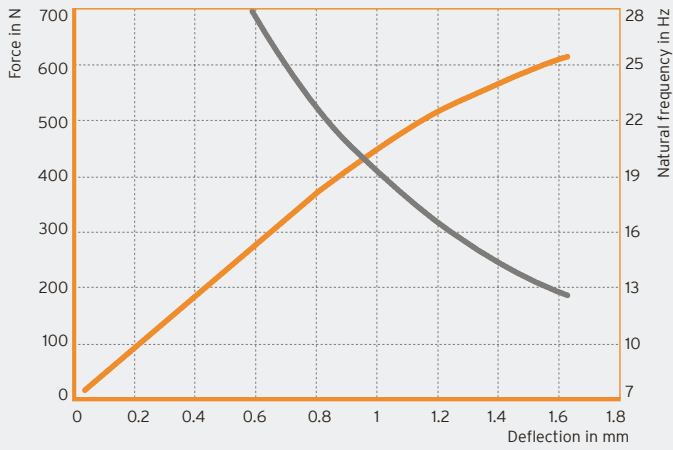

Isotop SE light 12-1

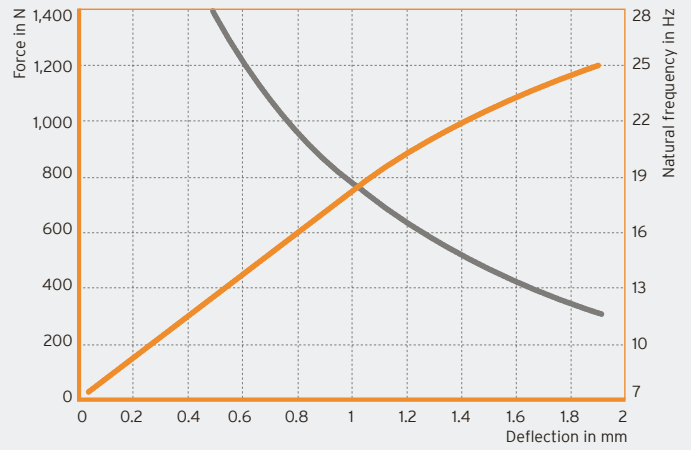

Isotop SE light 24-1

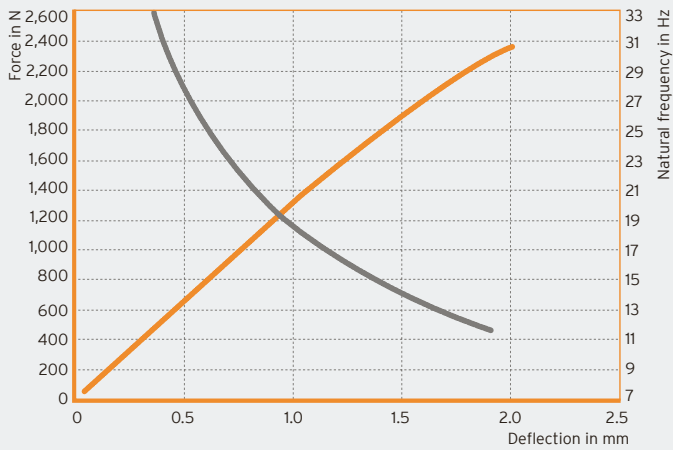

Isotop SE light 47-1

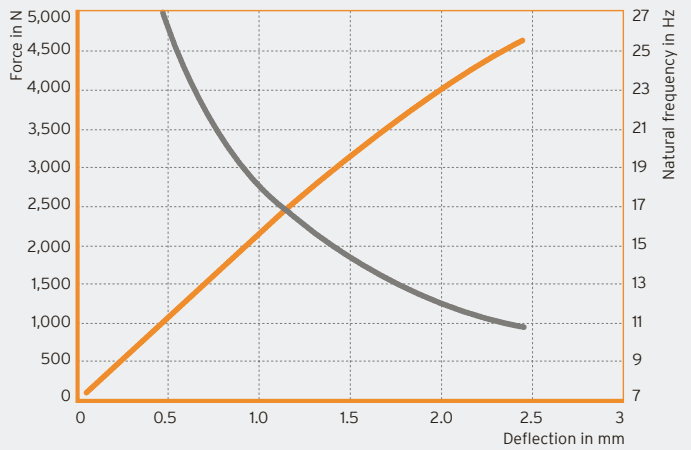

Isotop SE light 93-1

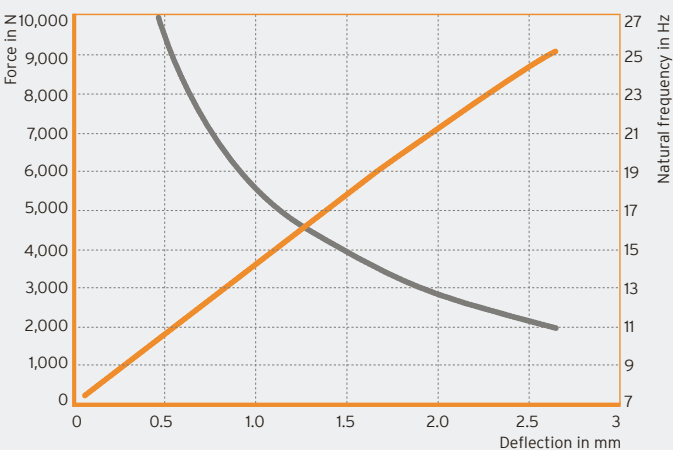

— Force in N
— Natural frequency in Hz

DB Isotop en © Copyright by Getzner Werkstoffe GmbH | 02-2021 | All information and data is based on our current knowledge. It can be used in calculations and for reference purposes, but is subject to product-specific and application-specific manufacturing tolerances and does not represent warranted properties. Material properties and their tolerances vary depending on the type of application and load and are available from Getzner on request. Subject to change without notice. For further general information, see VDI directive 2062 and glossary. Further characteristic values available on request.